

Pocket Door System

100% Steel



 Rocket Door Frames

"The quickest, easiest and best value for money"



Make the most
of your living space.

SINGLE Pocket Door



DOUBLE Pocket Door



SINGLE Frameless Glass Pocket Door



Contents

Page 04 Why choose a pocket door?

05 Why choose a **Rocket** pocket door?

06 Considerations before choosing

07 Studwork sizes

08 70mm Pocket

09 75/100mm Pocket

10 90mm Pocket

11 Double Pocket Doors

12 Frameless Glass Pocket Doors

13 Got a Solid Wall?

14 The “Jamb” Kit

15 Accessories

 **CONTACT US**

 0330 9980617

 info@rocketdoorframes.co.uk

SINGLE Pocket Door



More useable living space in your home

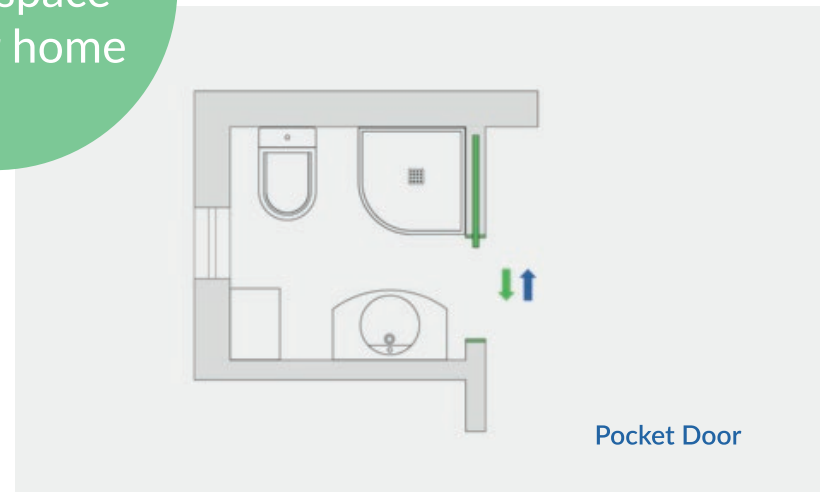

Why choose a Pocket Door?

Here's a question....are there advantages in using a hinged door over a pocket door?

They take up more space and make the space 'behind the door' unusable

Pocket doors open up that space, room for an armchair, chest of drawers, washing machine and so many more ideas.

Why Not?

If every door in a living space was a pocket door you would have almost 10% more usable living space, so the question was "Why use a pocket door", well it just makes good sense. Living room, dining room, utility, en-suite...the list goes on.

Make the most of your living space, choose a pocket door!



Why choose a Rocket Pocket Door?

Lifetime Guarantee 100% Steel

100% Steel pockets do not warp like timber pockets but have been expensive to produce until now. Our full steel system is galvanised to EN10346 standards with a 10 zinc coating ensuring a long, rust-free life. Quality runners are tested to more the 100,000 open and close cycles.



Product Knowledge

With more than 30 years experience in the pocket door market we have the right answers to all your questions. From initial project to installation advice we are ready to help you make the right decision.

At Your Service

We really are 'at your service' with technically trained personnel who want you to have the very best experience with us. We offer a next working day service for orders placed before 1.30pm on a weekday.



Value for Money

We have designed and installed innovative production machinery with the very latest technology that allows us to bring you a quality steel pocket door system at costs that are accessible to all.



Quickest and Easiest to Fit

The quickest and easiest fitted pocket door frame on the market. Click the horizontals to the verticals and then, with just 6 screws, the pocket is formed.

Quick, simple and no hassle.



Choosing the right pocket door

1 Sizing

page 8,9 and 10

What is your priority?
Door panel size? Overall Frame Dimensions? Passage Width? Pages 8, 9 and 10 will show you how to choose BUT first check out page 7 and select the size of studwork you will be using.

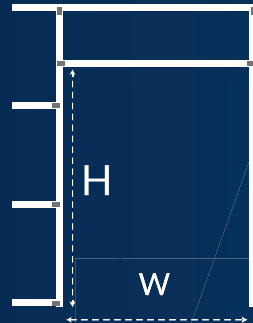

2 Studwork

page 7



Your installation will be simpler if the pocket thickness is similar to your studwork thickness, go to page 7 to find out how.

3 “Do I need a jamb kit?”

page 14

Jamb kits are timber lining kits that frame the door after installation and cover the top of the door/runners and metal pocket entrance verticals. Check them out on page 14.

4 “I’ve got a solid wall”

page 13

You can still use a Rocket pocket system, go to page 13 to find out how.

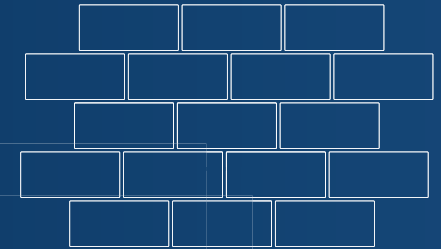

5 Want a frameless glass pocket door?

page 12

We offer a selection of frameless glass doors that slide effortlessly into the Rocket Pocket frame ideal for en-suites, utilities and wherever you need more light, see page 12.



6 Looking for a modern soft closing effect?

page 15

A soft closing device is part of our range of accessories, page 15.

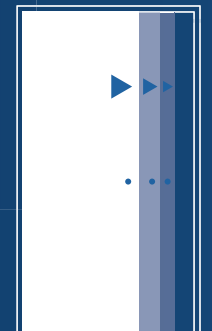

QUICK GUIDE on how to match your pocket door to the studwork

Studwork size

Studwork size

Installation

Use this Pocket door

63 mm Timber CLS



70mm Pocket
go to page 8

70 mm Steel



70mm Pocket
go to page 8

75 mm Timber

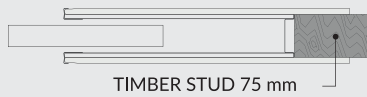

75mm Pocket
go to page 9

100 mm Timber

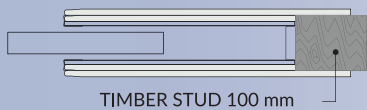

75mm Pocket
go to page 9

89 mm Timber CLS

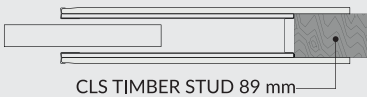

90mm Pocket
go to page 10

92 mm Steel



90mm Pocket
go to page 10

Timber
or Steel Stud



There are so many studwork sizes around so matching the pocket thickness to the studwork thickness becomes very important.

We manufacture Rocket pocket frames in 3 different thicknesses to make life easier when installing 70 mm 75 mm and 90 mm and these can be arranged to suit the majority of common studwork sizes. Check out the table opposite to choose the right pocket thickness for your stud.

70 mm Pocket Specs

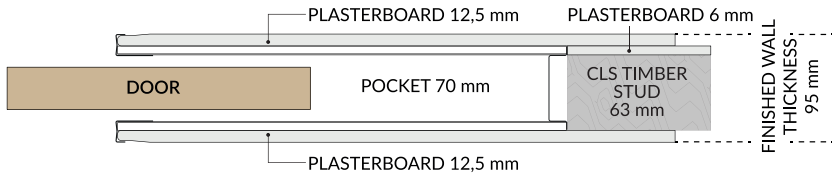

Pocket 70mm - Timber Stud 63mm CLS - Finished wall thickness 95mm

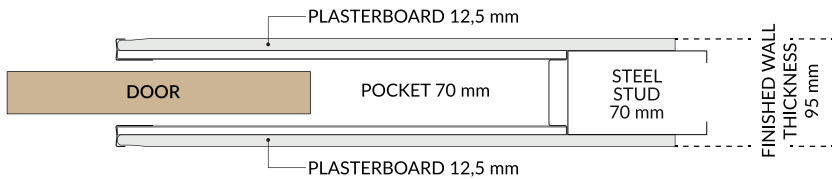

Pocket 70mm - Steel Stud 70mm - Finished wall thickness 95mm

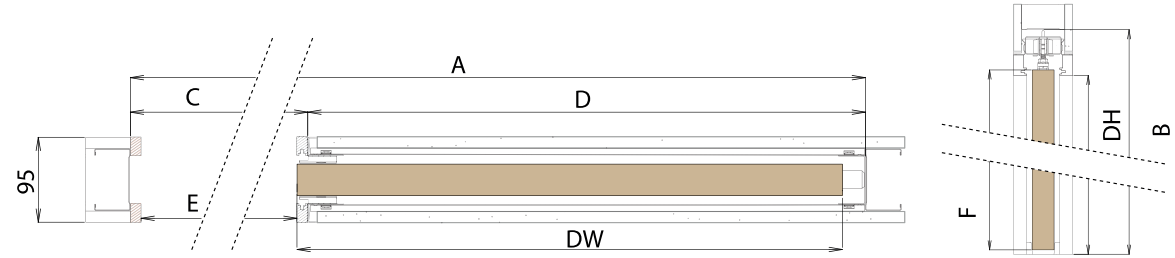

Pocket kit details

- Suitable for 35/44 mm doors (not supplied)
- Up to 60 KG maximum door weight
- Integral soft brake included
- Buy two single units to create a double door
- FD30 Fire rated option available
- If you have any queries please call our customer service team on 0330 9980617



DOOR PANEL		OVERALL DIMENSIONS		PASSAGE (WITHOUT JAMB KIT)	POCKET	FINISHED PASSAGE (INCLUDING JAMB KIT)	
WIDTH	HEIGHT	WIDTH	HEIGHT	WIDTH	WIDTH	WIDTH	HEIGHT
DW	DH	A	B	C	D	E	F
610 (2'0)	1981 (6'6)	1233	2042	609	624	585	1979
686 (2'3)	1981 (6'6)	1385	2042	685	700	661	1979
762 (2'6)	1981 (6'6)	1537	2042	761	776	737	1979
838 (2'9)	1981 (6'6)	1689	2042	837	852	813	1979
914 (3'0)	1981 (6'6)	1841	2042	913	928	889	1979
726	2040	1464	2101	724	740	700	2038
826	2040	1664	2101	824	840	800	2038
926	2040	1864	2101	924	940	900	2038
IMPORTANT ABOVE DIMENSIONS ARE +/- 4mm							
Install on finished floor level							
*When using 63mm 3"x 2" CLS stud a 6mm ply sheet will need to be added to bring this up to 70mm							

75 mm Pocket Specs

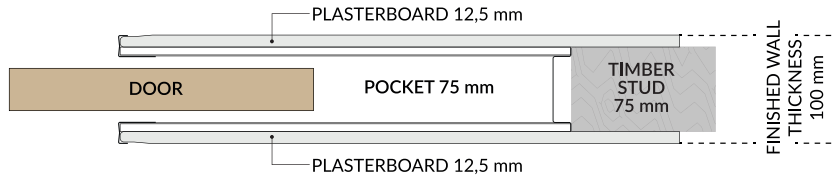

Pocket 75mm - Timber Stud 75mm - Finished wall thickness 100mm

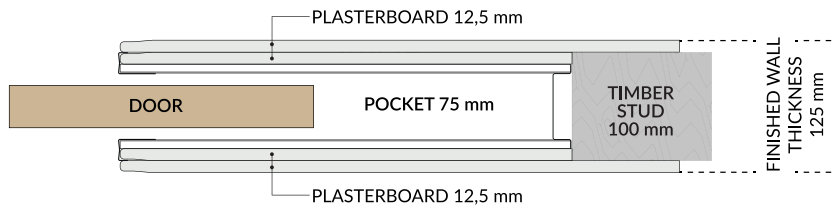

Pocket 75mm - Timber Stud 100mm - Finished wall thickness 125mm

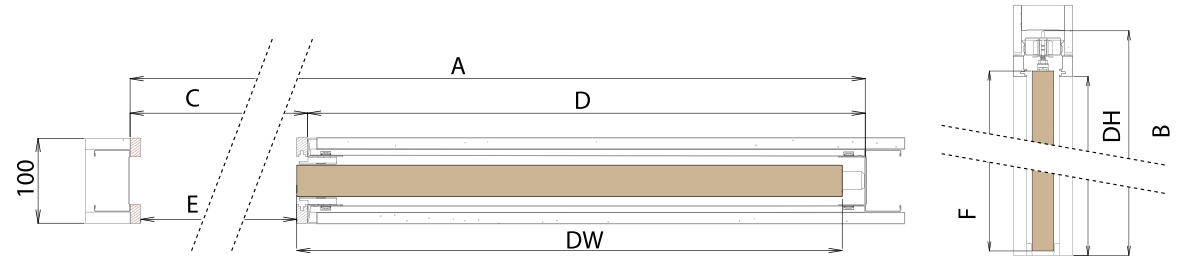

Pocket kit details

- Suitable for 35/44 mm doors (not supplied)
- Up to 60 KG maximum door weight
- Integral soft brake included
- Buy two single units to create a double door
- FD30 Fire rated option available
- If you have any queries please call our customer service team on 0330 9980617



DOOR PANEL		OVERALL DIMENSIONS		PASSAGE (WITHOUT JAMBS)	POCKET	FINISHED PASSAGE (INCLUDING JAMB KIT)		FINISHED WALL THICKNESS
WIDTH DW	HEIGHT DH	WIDTH A	HEIGHT B	WIDTH C	WIDTH D	WIDTH E	HEIGHT F	
686 (2'3)	1981 (6'6)	1385	2042	685	700	661	1971	100/125mm*
762 (2'6)	1981 (6'6)	1537	2042	761	776	737	1971	
838 (2'9)	1981 (6'6)	1689	2042	837	852	813	1971	
726	2040	1464	2101	724	740	700	2030	
826	2040	1664	2101	824	840	800	2030	
926	2040	1864	2101	924	940	900	2030	
IMPORTANT ABOVE DIMENSIONS ARE +/- 4mm								
Install on finished floor level								
*Double platerboard the 75mm frame to build out to 125mm (screwing through the track)								

90 mm Pocket Specs

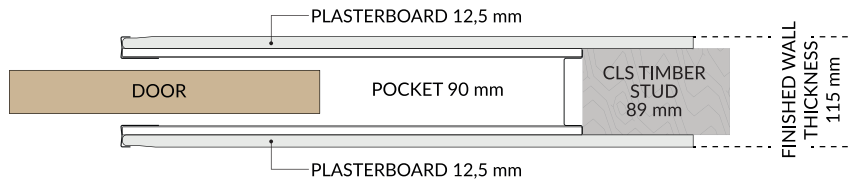

Pocket 90mm - Timber Stud 89mm CLS - Finished wall thickness 115mm

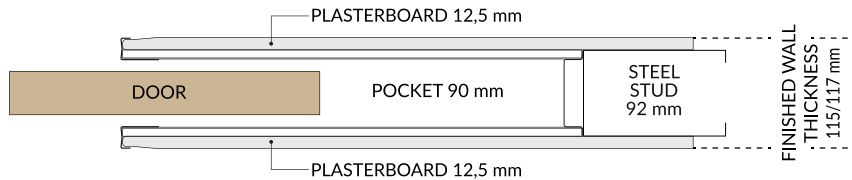

Pocket 90mm - Steel Stud 92mm - Finished wall thickness 115/117mm

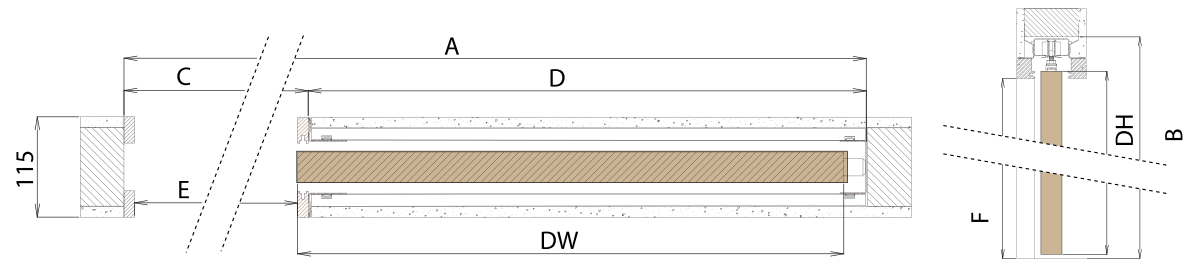

Pocket kit details

- Suitable for 35/44 mm doors (not supplied)
- Up to 60 KG maximum door weight
- Integral soft brake included
- Buy two single units to create a double door
- FD30 Fire rated option available
- If you have any queries please call our customer service team on 0330 9980617



DOOR PANEL		OVERALL DIMENSIONS		PASSAGE (WITHOUT JAMB KIT)	POCKET	FINISHED PASSAGE (INCLUDING JAMB KIT)	
WIDTH DW	HEIGHT DH	WIDTH A	HEIGHT B	WIDTH C	WIDTH D	WIDTH E	HEIGHT F
610 (2'0)	1981 (6'6)	1233	2042	609	624	585	1976
686 (2'3)	1981 (6'6)	1385	2042	685	700	661	1976
762 (2'6)	1981 (6'6)	1537	2042	761	776	737	1976
838 (2'9)	1981 (6'6)	1689	2042	837	852	813	1976
914 (3'0)	1981 (6'6)	1841	2042	913	928	889	1976
726	2040	1464	2101	724	740	700	2035
826	2040	1664	2101	824	840	800	2035
926	2040	1864	2101	924	940	900	2035
IMPORTANT ABOVE DIMENSIONS ARE +/- 4mm							
Installed on finished floor level							



1 + 1 = 2

It's so simple, so easy and so quick!

Every single kit comes supplied with an innovative joining bracket that allows you to join two singles to make a double.

No hassle, No extra joining kit (you save money!), it's just plain common sense.

Intimate to Open Plan

Double Pocket Door

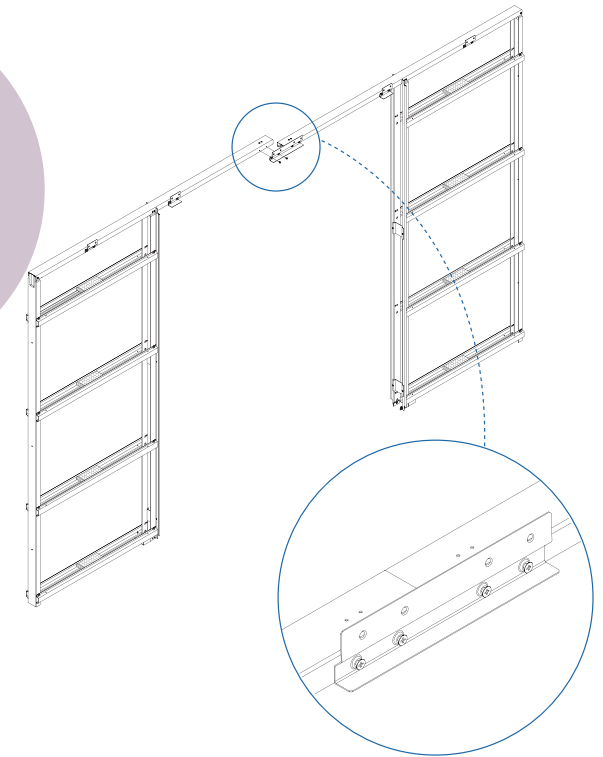

Dimensions

Because they are essentially two single systems connected together the overall dimensions are the same height and double the width of a single unit.

Frameless Glass Pocket Door

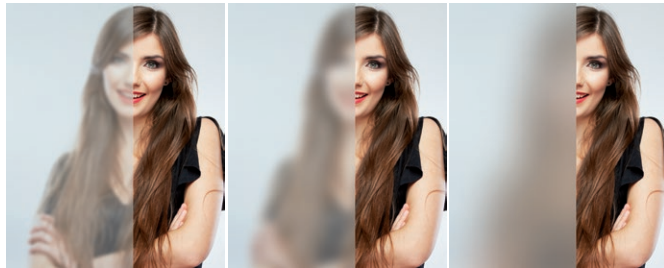

At 10cm

At 30cm

At 100cm

Our Glass

We only use glass manufactured in Europe to European safety standards. All our glass doors are safety tempered to EN12150. We supply satin glass which is an opaque finish generally regarded perfect for en-suites.

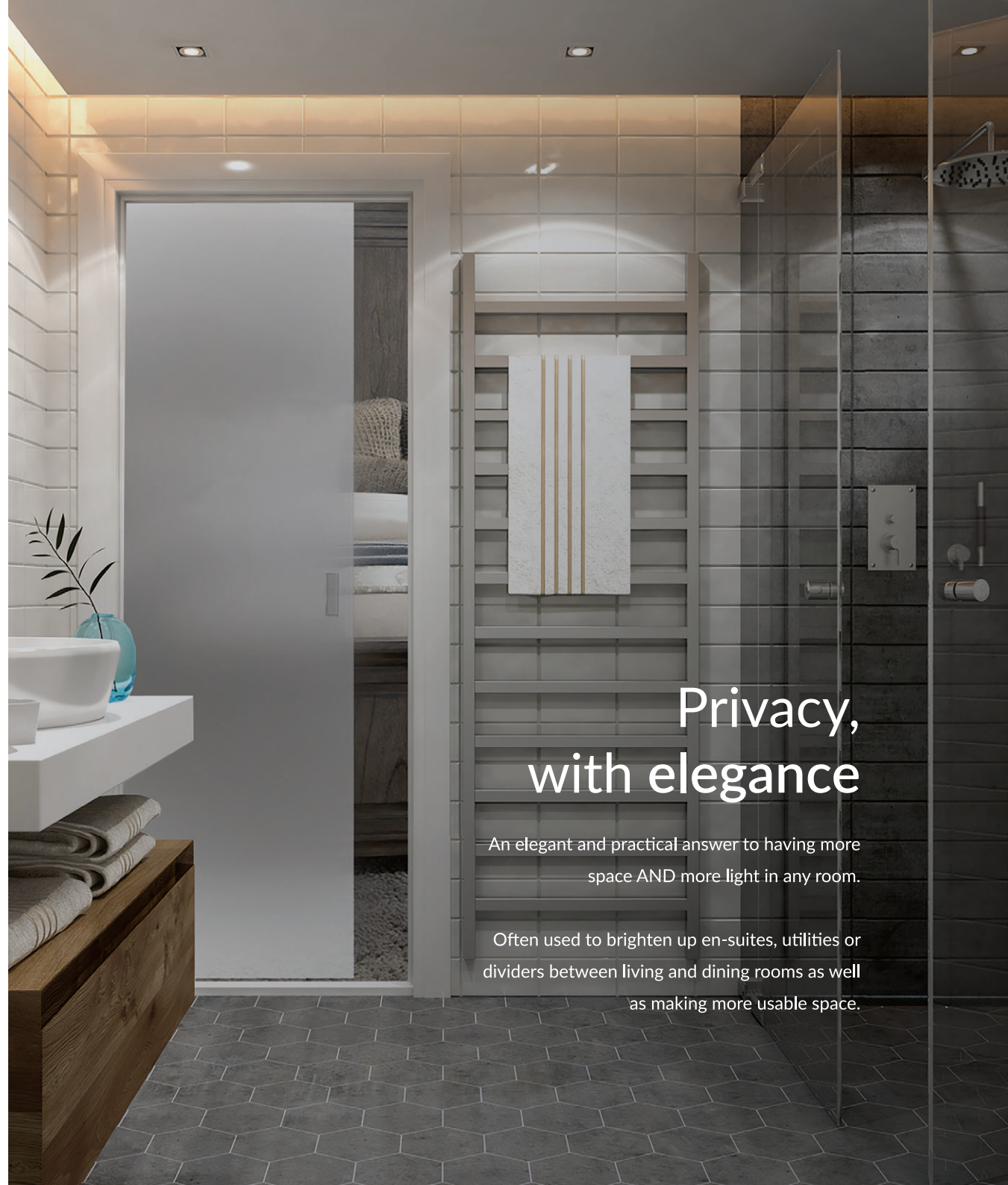

Privacy, with elegance





An elegant and practical answer to having more space AND more light in any room.

Often used to brighten up en-suites, utilities or dividers between living and dining rooms as well as making more usable space.

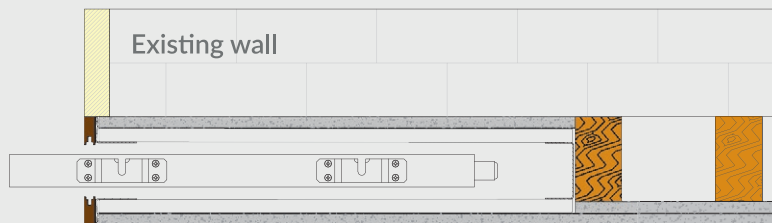
Got a solid wall? No problem

Just create a false wall along side the existing one. You can still use a Rocket Pocket door even if you have an existing solid wall. A quick and easy solution with no need for knocking out bricks or lintels etc.



-  89 mm CLS
-  12,5 mm Plasterboard
-  Jamb Kit
-  Timber Liner (Not Supplied)





The
Finishing
Touch

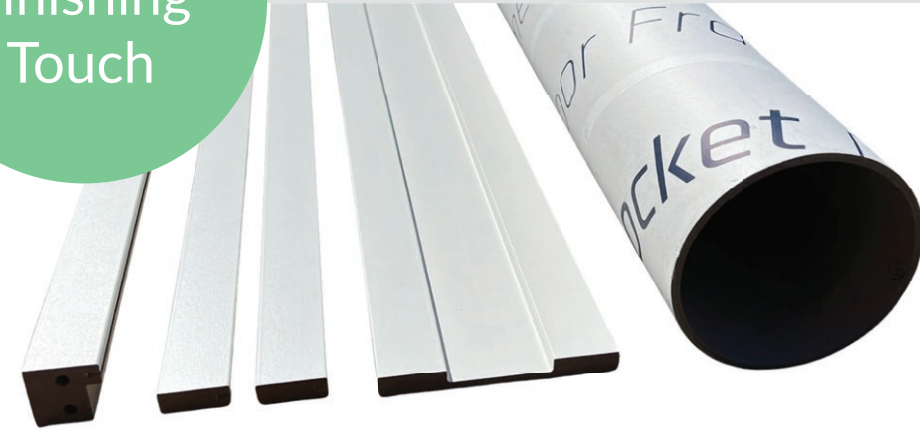

The “Jamb” Kit

What are they ?

The jamb kit is essentially a timber lining kit fitted after the door to cover the top of the door, runner etc and line the metal entrance verticals to the pocket to give a clean professional finish.

Do I need one?

We can provide a simple jamb kit as an accessory; it is manufactured from MDF and can be painted to the colour you desire.

Alternatively you can provide your own if you wish to have a specific type of wood/finish.

Accessories

1. Soft Closer

A quick fit soft close system that dampens the door when closing, stops it from banging and gently closes the door for you. You do need to push the door first, it's a similar action to kitchen drawer soft closers. We have a system for doors up to 35kg which are most modern doors and a system for doors from 35 to 45 kg.

2. Glass Door Soft Closer

This is a soft closer designed specifically for Rocket Pocket Frameless glass doors.

3. Self Closer

This differs from the soft closer, you just open the door, pass through and the self closer closes it for you. Timber doors only.

4. Door Furniture

Round or Square Flush pulls and bathroom locks in satin chrome make an elegant finish to your pocket door.

5. Jambs

A timber lining kit that covers the metal frame and runners.

6. Push Pull

Ingenious idea for when you want the door to be fully back into the pocket most of the time. Push the door back into the pocket and it remains there. Then with a simple push on the leading edge of the door it pops out of the pocket for you to close.

1.Soft Closer



2.Glass Door Soft Closer



3.Self Closer



4.Door Furniture



5.Jambs



6.Push Pull



Pocket Door System

100% Steel

www.rocketdoorframes.co.uk

"The quickest, easiest and best value for money"

Our new state-of-the-art facility in N.E. Italy has over 6000 m² of photovoltaic cells supplying almost 100% of our electrical needs.



We have an ethical approach to modern manufacturing.



We use only 100% recycled steel, recyclable carton and our jamb kits are FSC approved.

 **Rocket Door Frames**

Office & Return Address:

Rocket Door Frames

Unit 14 Priest Court , Springfield Ind Est,

Grantham - NG31 7FZ

 0330 9980617  info@rocketdoorframes.co.uk

The information in this document is subject to change without notice and should not be construed as a commitment by Rocket Door Frames (RDF). RDF assumes no responsibility for any errors that may appear in this document. In no event shall RDF be liable for incidental or consequential damages arising from use of this document.

© Rocket Door Frames 2024